



Municipal District of Big Lakes: Rural Addressing System

In order to have this program be completed as soon as possible and with few complications we are asking for everyone to help us out.

First we must understand that the focus of this system is to aid emergency responders when they are called out to an incident in the rural community. We have been in collaboration with the RCMP, the EMS and the Fire services, and everyone at these organizations is eager to get this system in place.

This project is scheduled to begin in the summer of 2007. But before we put any signs in the ground, we want to know how you would prefer to have your sign displayed.

The signs are going to look like the example in Diagram 1.

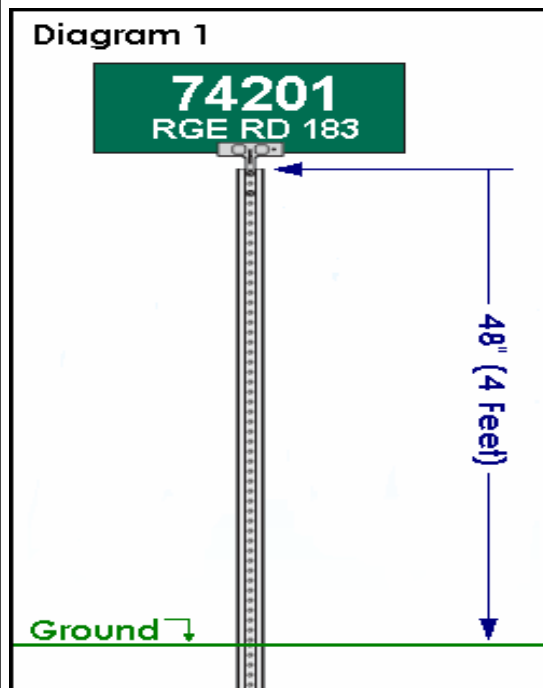

This is an example of what the signs will look like and how they will be mounted. The post that the sign sits on top of will be approximately 4 feet tall, tall enough to be visible year-round.

Please Note:

If you have an alternate method of attaching a sign, for instance you have a fence, or a post already in the ground, and you would prefer your sign to be located there, please contact us to let us know. Not having to put a post in the ground will ensure that we will get this whole system up faster.

The sign must be visible at all time of the year, regardless of weather conditions.

Thanks for your help!

Understanding Your Rural Address

Why it is important, and how to use it.

Your Property Access Number:

Like on the city streets, odd and even numbers will be on opposite sides of the road.

From the examples on the right, 01 means that your driveway is within 100 metres of the corner of the section.

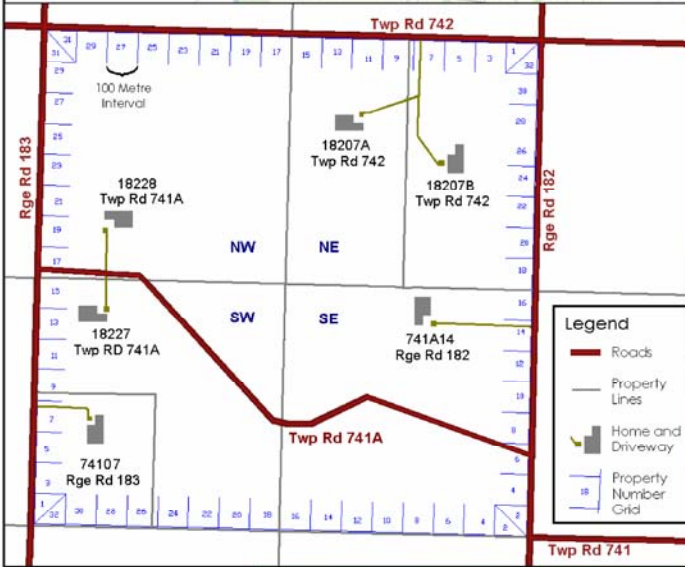

Is your driveway off of a Range Road?

If so, here is an example of what your rural address and sign may look like.



742
This is the number of the Township Road to the South of your property.

01
This is the property access number.

183
This is the number of the Range Road which your property is accessed off of.

Is your driveway off of a Township Road?

If so, here is an example of what your rural address and sign may look like.

183
This is the number of the Range Road to the East of your property.

01
This is the property access number.



742
This is the number of the Township Road which your property is accessed off of.

Municipal District of Big Lakes

The new addressing system benefits everyone involved, from Emergency Responders down to helping a friend get to your home. It is crucial for everyone to understand it.



Do you need any more information?
If so contact us.
Call: (780) 523-5955
Email: biglakes@mdbiglakes.ca

