

Big Lakes Community Sustainability Plan  
Public Meetings  
**CHARTING THE FUTURE OF BIG LAKES**

Through the leadership of your municipal representatives, the Municipal District of Big Lakes has undertaken a long-term planning project. This project will establish the direction of the municipality over the next 10 years. While this project is still in its early stages, key goals currently identified include:

- Safe and viable communities in both rural and urban settings*
- Maximize economic development opportunities*
- Municipal leadership in the field of environmental stewardship*
- Municipal excellence in responsible financial planning*
- Transparent and Accountable municipal governance*

Are you interested in how these goals will be achieved?  
Do you have ideas on how they should be achieved?  
If you are, then please attend one of these sessions.

<b>FAUST</b> Tuesday, June 10 <sup>th</sup> 7:00 p.m. Northern Lakes College (Campus)	<b>GROUARD</b> Wednesday, June 18 <sup>th</sup> 7:00 p.m. Northern Lakes College (Campus)
---	---



**“NOTICE”**  
*2008 Household Hazardous Waste*  
**ROUND-UP**  
Sat. - June 07, 2008  
3 pm to 7pm  
**SPORTS PALACE**  
5409-49 St.  
High Prairie

For the convenience of ratepayers  
our M.D. office in High Prairie  
will be OPEN during noon  
For the entire month of June 2008!



Regional Landfill Authority  
MD Transfer Stations  
2008 Summer Hours



<b>Banana Belt</b>	<b>(Pt.NE-11-73-17-W5)</b>
Wed. & Sun.	11:00 am - 7:00 pm
<b>Enilda</b>	<b>(SE-01-74-16-W5)</b>
Open 24 hours —bagged household waste only	
<b>Faust/Kinuso</b>	<b>(SE-07-73-10-W5)</b>
Wed	11:00 am – 7:00 pm
Sun	11:00 am – 9:00 pm
<b>Grouard</b>	<b>(Pt.NE-32-75-17-W5)</b>
Wed	12:00 noon - 8:00 pm
Sun	11:00 am – 9:00 pm
<b>Heart River</b>	<b>(NE-31-76-17-W5)</b>
Wed.	1:00 pm - 9:00 pm
Sun.	10:00 am - 5:00 pm
<b>H.P. West/Gilwood</b>	<b>(NW-24-74-18-W5)</b>
Open 24 hour — bagged household waste only	
<b>Joussard</b>	<b>(NW-33-73-13-W5)</b>
Wed	12:00 noon - 8:00 pm
Sun	11:00 am – 9:00 pm
<b>Regional Landfill</b>	<b>(NW-9-73-15-W5)</b>
Mon /Thurs /Sat	10:00 am – 5:00 pm
( located approx 12 km south of Hwy 2 on East Prairie road.)	
Phone: 523-5760	

There is no charge to MD Residents for disposal of white goods and tires at the Regional landfill and also the Joussard, Banana Belt, Heart River, Faust/Kinuso and Grouard transfer stations.

**M.D.**  
**On-Call**  
**(24 hrs)** **523-5955**  
Toll Free: 1-866-523-5955

**MD of Big Lakes NEWSLETTER**

Ph: (780)523-5955 Fax: (780)523-4227 Web: [www.mdbiglakes.ca](http://www.mdbiglakes.ca)  
Toll Free: 1-866-523-5955 Email: [biglakes@mdbiglakes.ca](mailto:biglakes@mdbiglakes.ca)  
Box 239, High Prairie AB T0G 1E0



W  
E  
L  
C  
O  
M  
E  
  
T  
O  
  
S  
U  
M  
M  
E  
R  
  
2  
0  
0  
8

Summer Greetings from the MD of Big Lakes.

On behalf of Council I would like to wish you all a great summer – with sunny days for baling hay, or for enjoying the pristine lakes in our region.

For those of you that have participated in our public meetings to assist with building the vision and setting goals for our municipality, I thank you, for your interest in your community, and for getting out to provide valuable input.

For those that will be attending our upcoming meetings in Faust and Grouard, I look forward to meeting you and receiving your feedback.

And for everyone, you are invited once again to our annual barbeque luncheon on June 26<sup>th</sup>. At that time we will present the vision and goals that you helped to set for our municipality.

Hope to see you there!

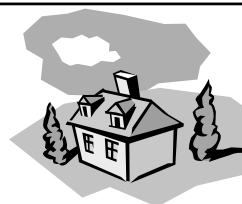

**“ NOTICE ”**  
**2008 PROPERTY TAXES**

This is to advise the ratepayers of the M.D. of Big Lakes that the combined tax and assessment notices were mailed prior to May 22, 2008.

The **due date** for payment is **June 30th, 2008**. A penalty of 7.5% will be applied to all unpaid taxes on July 1st, 2008. A further penalty of 7.5% will be applied by January 1, 2009 on outstanding property taxes as of December 31, 2008.

Failure to receive a tax notice does not alleviate assessed property from property taxation.

***If you do not receive a property tax notice by May 31, 2008—please contact our office.***

Arrangements have been made at the Royal Bank (High Prairie only) to accept payments for property taxes.

When paying at the bank please remember to bring your remittance portion of your tax notice.

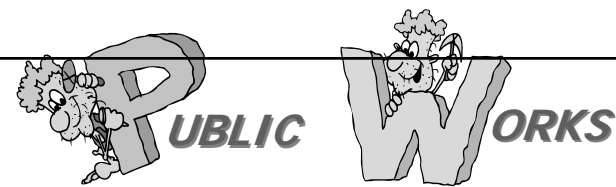

The MD of Big Lakes Public Works Department has several road construction and water system upgrades planned for 2008. The more notable projects include:

- TWP 740 (Gilwood Road) major upgrade. The 11.9 km road, including a 6.1 meter (22ft) multi-plate culvert will be completed in early summer 2008. Further upgrading including paving is scheduled within the next 2 or 3 years.
- The MD of Big Lakes will be constructing 2.5 mile road projects this summer. These projects will be completed using MD expertise and equipment. Additional contracted equipment will be used whenever required.
- Sucker Creek Drainage Project. This project involves the rehabilitation of the existing drainage structure including the replacement of several drop structures and the construction of 1 mile road
- Pilot Plant Studies will be underway during the summer at the Grouard and Faust water treatment plants. These studies will involve the installation of filtration membrane pilot plants to determine the filtration requirements to meet future standards. The MD of Big Lakes is committed to providing the highest quality water to customers of our water distribution systems.

and, as always, we have all of our maintenance programs about to start. They include:

- 240 miles of road re-gravelling
- 25 miles of road re-shaping (shoulder pulling)
- 10 miles of ditch cleaning
- 25 miles of roadside brushing



**GRADING PRIVATE DRIVEWAYS**

Grading of private driveways may be provided by the Municipal District to residents on a cost recovery basis. **The cost of each grading will be a minimum of \$35.00 + GST.** Agreements are available at the M.D. Administration office in High Prairie. Driveways will **NOT** be graded unless an Agreement is signed in advance.

**Note:** Private driveways are generally graded **ONCE** road maintenance is complete.

**MUNICIPAL DISTRICT OF BIG LAKES PUBLIC NOTICE**

**Development Permit Fees**

In accordance with the Municipal District of Big Lakes Schedule of Fees Amending Bylaw No. 07-2008, the penalty for development that has begun prior to obtaining a development permit was changed to double the regular fee plus \$100.00 per \$100,000 per development.

*Example: A developer who has constructed or begun construction on a building valued at \$200,000 without an approved permit from the M.D. of Big Lakes shall be subject to the following:*



Development Permit Fee:	\$120.00
Penalty:	<u>\$200.00</u>
Total:	\$320.00

**This penalty shall come into force and effect on September 1, 2008.**

**"SENIORS WEEK CELEBRATIONS"**

**June 2nd - June 7th**

**Monday June 2nd**

**11:30am-2:30pm Senior Wellness and Information Fair** to be held at the downtown Elks Hall. Snacks & refreshments will be provided as well as many door prizes to be given away.

**Tuesday June 3rd**

**11:30am-1pm Chowder, Soup and Chili** will be served at the Elks Hall (downtown location)

**1pm-3pm Seniors Bingo** to follow after the lunch

**Wednesday June 4th**

**12:00pm-2:30pm Sit down Fancy Luncheon**, with lots of prizes to give away. Held in the Village of Kinuso at the Agricultural Hall.

**Thursday June 5th**

**11:30am-2pm BBQ and Bocce Ball Tournament** to be held at the Jay Cee Park in High Prairie. If it's raining this will be held at the Golden Age centre.

**Friday June 6th**

**11:30am-2:00pm Barbeque Beef on a bun with salads.** Held at the High Prairie Sports Palace (Curling Rink). Entertainment will also be provided.

**1pm-5pm High Prairie & District Museum** will be holding an open house and refreshments will be provided.

**Saturday June 7th**

**2pm-4pm Strawberry Tea**— Held at the High Prairie Library. Come out and enjoy a bit of humor and strawberry delight.

**For any further inquiries, please call Big Lakes Family & Community Services at 536-0062**

# "Big Lakes FCSS Summer News"

## Safety First for a Fun Summer

As you gear up for the summer, think safety, while you bike, camp, boat, swim, golf, fish and enjoy the hazy days of summer. Nothing puts a damper on this time like an avoidable accident. Wear a helmet for biking or quading. Remember brain cells are damaged easily.

## F.C.S.S. Summer Office Hours

The F.C.S.S. offices in Grouard, Enilda, Jousard, Faust and Kinuso will be closed during July and August with regular hours resuming in September. If you require assistance you can call the High Prairie office at 536-0062 or the Director at 776-0008.

Big Lakes FCSS

"Making a difference in your community"

*"Museums are Now Open for the Season"*



## 2008 MUNICIPAL TAX AND SCHOOL LEVY NOTICE

On May 14, 2008 the MD of Big Lakes Council passed its 2008 Capital and Operating Budgets, and gave final reading to the 2008 Mill Rate By-Law.

The deadline for payment, without penalty, is June 30, 2008. A penalty of 7.5% will be applied to all tax accounts with an outstanding balance on July 1, 2008. Payments can be made by mail, or in person at the MD of Big Lakes administration building in High Prairie. The MD office will be open during the noon hour for the month of June for your convenience. "On-line" payment via TD Canada Trust or the Royal Bank is also available, or in person at the High Prairie Royal Bank.

According to provincial law, the rate of taxation, "mill rate", is applied to assessment of property value each year. Due to market inflation, residential assessment increased substantially throughout the MD, particularly along the south shore of Lesser Slave Lake. This increased assessment is counterbalanced this year with a reduction to the residential/farmland mill rate as well as a reduced school mill rate. Annually, the province dictates the amount that each municipality must provide for school funding, "requisitions", and the school tax rate is then set accordingly.

For those of you that have concerns with your assessments, please contact our assessors, Compass Assessment Consultants Inc. at 1-800-251-9711.

2008 Mill Rates			
Assessment Class	Municipal Rate	School Rate	Total Mill Rate
Residential	3.000	2.766	5.766
Farmland	3.000	2.766	5.766
Non-Residential	11.500	4.873	16.373
Machinery & Equipment	11.500	-	11.500
Linear	11.500	4.873	16.373

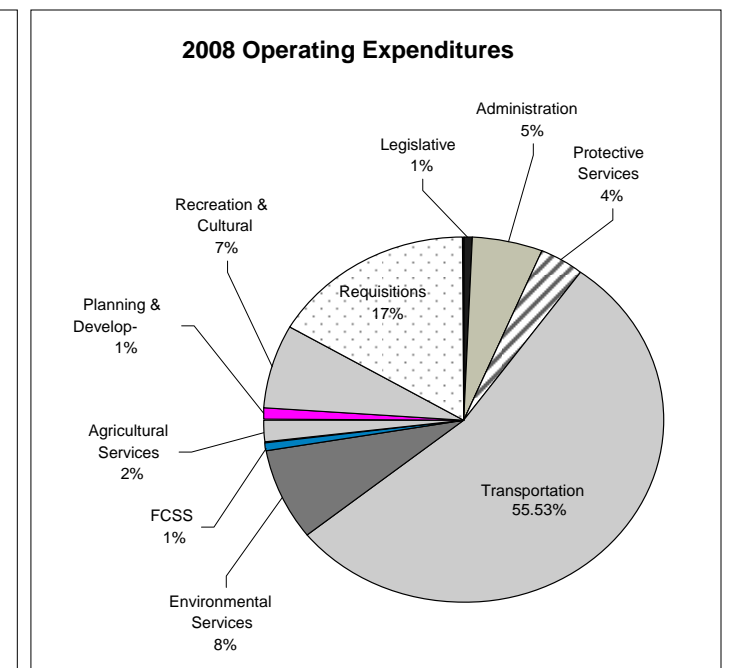
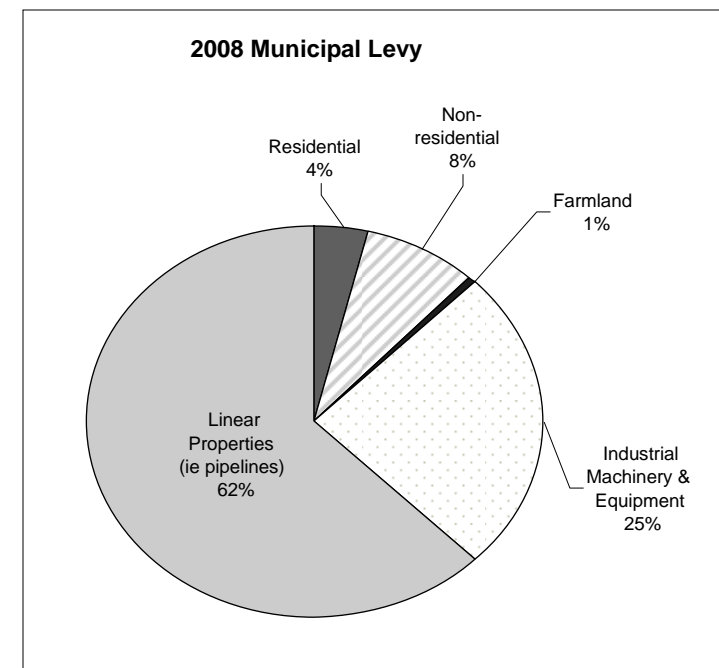

## Agriculture Service Board Report - Gary Braithwaite, Agricultural Fieldman

### Roadside Haying

For producers looking to hay the municipal road allowance ditches they should obtain a Roadside Haying Permit from the MD. First priority is given to the adjacent landowner up until June 15 after such time permits will be handed out on a "first come, first serve" basis. It is recommended that applicants apply early to avoid the MD roadside mowers from cutting the roadside vegetation prior. For haying permits along the primary and secondary highways contact Alberta Transportation at 523-6591.

### Rental Equipment Program

Equipment available to rent by MD ratepayers include land scrapers, land rollers, trailer sprayers, backpack sprayers, quad sprayer, cattle squeeze, loading chute, corral panels, post pounder, bran applicator (for grasshopper control or seeding), truck-mount seeders, quad seeder, hand seeder, post hole auger, trailer mounted tree spade for larger trees (up to 3 meter heights tree fogger for control of insect tree pests, hydraulic wire spooler for gathering up fencing wire, and 10 foot brush mower.

### Fenceline Spraying Program

This program involved the spraying of weeds bordering fencelines of MD road allowances. It provides control of the weeds that are typically missed by both the landowner and the MD. Since there is potential for minor crop damage along the perimeter of the landowner's field authorization is required prior to spraying. There is no charge to the landowner for this work.

### Crop Pests - Clubroot

To latest new pest affecting canola is Clubroot. This fungi-like pest, which infects the underground rooted portion of canola plants, was declared a pest under the Agricultural Pests Act of Alberta in 2007. It is currently expanding outwards from the Leduc area.

The Agricultural Pests Act of Alberta requires a municipality to "take active measures to prevent the establishment of, or control or destroy pests in the municipality" (Sec. 6)

Inspectors will be visually checking most of the Canola fields for Clubroot in the Municipality annually. Priority of inspection will be given to fields where:

- The producer has recently purchased farm or earth moving equipment from outside the Peace Region
- earth moving equipment i.e. pipeline, drilling or service rigs or road construction type equipment from outside the Peace Region has been on the land

Inspectors will be watchful of Canola appearing with symptoms of Clubroot (wilting, stunting, yellowing and early maturity) which typically appears at or the entrance to agricultural lands in canola.

Inspectors will be wearing sanitary footwear during Clubroot inspections within Canola fields.

As per MD Policy, if Clubroot is found within the boundaries of a Peace Region Municipality, the landowner will be asked to adopt the following measures:

- Harvest the crop with the canola seed being sold to be crushed, but not sold as feed or kept for seed; straw from the crop is to be chopped & spread back onto the field, it is not to be baled or removed;

- Tarp any loads being transported from the infested land;

- Clean any crop residue and soil from all equipment and implements before taking it off the infested land, and sterilize implements or the parts of the implement which come directly in contact with the soil using a 1 – 2% bleach solution, for the next 4 years;

- Seed a non-host crop and/or perform chemical-fallow, ensuring volunteer canola and susceptible mustard family weeds are controlled for 4 or more consecutive years from initial infestation.

For more information on Clubroot see Alberta Agriculture's web site at :

[http://www1.agric.gov.ab.ca/\\$Department/deptdocs.nsf/all/agdex11519](http://www1.agric.gov.ab.ca/$Department/deptdocs.nsf/all/agdex11519)

## Speeding Facts

Speeding is one of the most common causes of accidents on Alberta's streets and highways.

There are as many reasons for speeding as there are days in the month, but none of them are legitimate.

### **Why do we do it? The most common reasons heard are:**

- I drive fast because I'm a good driver.
- I have fast reflexes so I can drive faster.
- I have to keep up with the traffic.
- Other drivers do it.
- I've been driving for years and never had a collision.
- I am really late for an appointment.

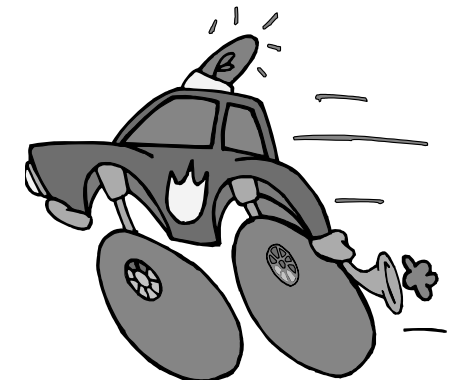

### ***Did you know?***

Speeding is a contributing factor in many fatal crashes. Some drivers think driving a few kilometers an hour over the posted speed limit is an acceptable risk because they believe the worst that can happen is receiving a speeding ticket. They are wrong. Speeding:

- Reduces your ability to steer safely around curves or objects in the roadway.
- Decreases your field of vision and your peripheral vision (on both sides).
- Extends the distance required to stop your vehicle in emergency situations.
- Increases the chances that you will lose control of your vehicle.
- Reduces the effectiveness of seat belts and other safety devices such as airbags and side impact beams.
- Increases probability of death or injury if there is a crash.
- Reduces the effectiveness of roadside hardware such as barriers, crash cushions and bridge rails.

### ***Know the limits***

Again, speed limits do not indicate the speed you should travel; they are the maximum speeds permitted if conditions are favourable. The next time you head out, know and obey the rules:

- In Alberta, the speed limit is 50km/hr in urban areas and 80 km/hr on rural roadways unless otherwise posted.
- Use common sense. Slow down on unfamiliar roads.
- Slow down in school zones and playground areas. Obey all posted speed limits.
- Observe and follow all posted limits when traveling through a construction zone.

Use your head before putting the pedal to the metal. The few minutes you might save by speeding aren't worth the potential losses: fines, damages and potential injuries or death.

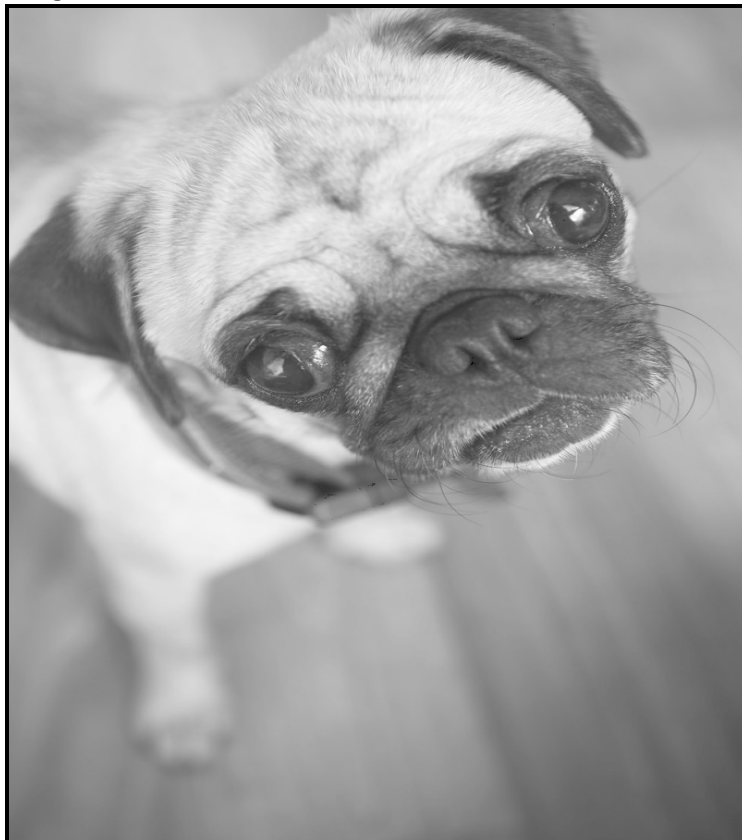

# My dog tag is my ticket Home!

## The first step in responsible dog ownership is to licence your dog.

The MD of Big Lakes Animal Control Bylaw (which has been in effect since 1995) requires all dogs over the age of six months to be issued and wearing a dog tag. The dog tag is valid for the life of the dog unless the dog changes owners or moves to another municipality.

Dog tags are available at the MD office in High Prairie and they are **FREE** of charge. If your dog is picked and it is wearing a tag, attempts will be made to contact and return the dog to the owner instead of impounding the dog (for first offence), which will save you over \$100. in fines and impound fees. Any dog that is picked up that is not wearing a tag will be impounded even if it is known who the owner is.

## Understanding Your Rural Address

Why it is important, and how to use it.

### Your Property Access Number:

Like on the city streets, odd and even numbers will be on opposite sides of the road. From the examples on the right, 01 means that your driveway is within 100 metres of the corner of the section.

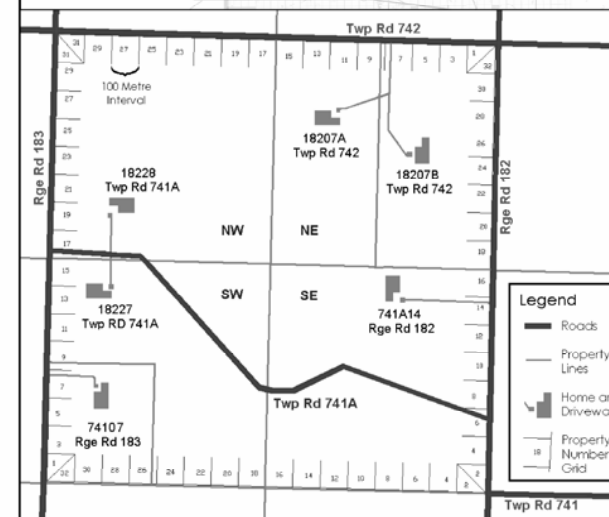

Is your driveway off of a Range Road?

If so, here is an example of what your rural address and sign may look like.

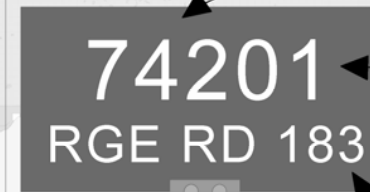

**742**  
This is the number of the Township Road to the South of your property.

**01**  
This is the property access number.

**183**  
This is the number of the Range Road which your property is accessed off of.

Is your driveway off of a Township Road?

If so, here is an example of what your rural address and sign may look like.

**183**  
This is the number of the Range Road to the East of your property.

**01**  
This is the property access number.



**742**  
This is the number of the Township Road which your property is accessed off of.

## Municipal District of Big Lakes

The new addressing system benefits everyone involved, from Emergency Responders down to helping a friend get to your home. It is crucial for everyone to understand it.

Do you need any more information?  
If so contact us.  
Call: (780) 523-5955  
Email: biglakes@mdbiglakes.ca



## **SAFETY TIPS FOR WEATHER EMERGENCIES**

Plan ahead for weather emergencies. Take the time now to choose the best shelter within your home or office. Try to choose a small interior room or stairwell, ideally with walls reinforced with pipes (eg; bathroom) or concrete (e.g. basement), on the lowest floor of the building. Make sure everyone concerned knows where to go and what precautions to take (below). Also, choose a meeting place where your family can gather after a severe storm, to ensure that you are all safe and accounted for.

Maintain an emergency pack with battery powered flashlight, radio, tools for emergency repair, food supplies, first-aid kit, prescription drugs, blankets and extra clothing. Keep your car gas tank full, in case gas stations close down after a storm. If a SEVERE WEATHER WATCH is issued, bring all livestock to shelter, secure or put away loose objects like lawn furniture, listen for weather updates and watch the skies.

When a WARNING is issued keep calm, close all windows and doors, bring children indoors and go to your shelter.

### Summer Warning and Watch Criteria



**Watch:**

A bulletin alerting you that conditions are favorable for the development of severe weather. Persons in the areas specified should be on the lookout for severe weather conditions and listen for updated watches and possibly weather warnings.

**Severe thunderstorm watch:**

Conditions are favorable for the development of severe thunderstorms with large hail, heavy rain, intense lightning or damaging winds within the areas and times specified in the watch.

**Tornado watch:**

Conditions are favorable for the development of tornadoes within the areas and times specified in the watch.

**Warning:**

A bulletin warning you that severe weather is occurring or that hazardous weather is highly probable. Severe thunderstorm or tornado warnings may be issued less than one hour in advance. Other weather warnings may be issued six to twelve hours in advance. The following are some of the more common warnings issued by Environment Canada. Note that criteria for warnings are established to meet local and regional needs and may vary slightly from region to region across Canada.

**Severe thunderstorm warning:**

A severe storm has developed, producing one or more of the following conditions: heavy rain, damaging winds, hail, or intense lightning. Severe thunderstorms may also produce tornadoes. The storm's expected motion and developments will be given in the warning. If you are in the area specified, take precautionary measures. Criteria are hail 20 mm or more in diameter, winds gusting to 90 km/h or more, rainfalls of 50 mm or more in 1 hour (30 mm or more in AB), or 75 mm or more in 3 hours.

**Tornado warning:**

One or more tornadoes are occurring in the area specified. The expected motion, development and duration will be given in the warning. If you are in the path of a tornado, take emergency precautions immediately. If you are near the area specified in the warning be alert for the development of additional tornadoes or severe thunderstorms.

**Heavy rain warning:**

Issued when heavy or prolonged rainfall is sufficient to cause local/widespread flooding. Expect 50 mm of rain over a 12 hour period or less, or 80 mm of rain in less than 24 hours. (50 mm of rain over a 24 hours or less in areas North of 60)

For daily information on weather you can check out this website: [www.weatheroffice.ec.gc.ca](http://www.weatheroffice.ec.gc.ca)

WEATHER EVENT	IN BUILDING	OUTSIDE	IN VEHICLE OR MOBILE HOME
 <b>FLOODING</b>	<p>If your house is in a low lying area be prepared to move to higher ground during flood watches.</p>	<p>Seek shelter. Do not try to walk through flash floods.</p>	<p>Avoid driving through flooded areas. If caught there, watch for road washouts and avoid dips and underpasses.</p>
 <b>LIGHTNING</b>	<p>Close windows and doors and keep away from windows, doors and fireplaces. Don't go outside unless it is absolutely necessary. Before the storm hits, unplug appliances including radio, and television and computers and do not touch electrical items or telephones during the storm. Do not take a bath (both water and metal are electrical conductors).</p>	<p>Get inside a vehicle or building if possible. Avoid water and objects that conduct electricity (eg; tractor, golf clubs, metal fence, bicycle). Do not stay in open spaces or under tall objects (trees, poles). If no shelter is available crouch down, feet close together with your head tucked down. If in a group, spread out, keeping people several yards apart.  Remember, lightning victims can be revived with CPR even when there is not a pulse.</p>	<p>Stay in the vehicle with windows closed. Be wary of downed power lines that may be touching your car. You are safe in the car but may receive a shock if you step outside. Avoid touching metal parts of the vehicle. Do not drive—wait. But don't park under the trees or other tall objects that may fall over in the storm.</p>
 <b>WIND / TORNADO</b>	<p>Stay inside with the doors and windows shut. Stay away from windows, doors and exterior walls. Go to a small interior room or stairwell on the lowest floor of the building (bathrooms are often the best choice). If possible crouch under heavy furniture. Protect your head with a cushion or a mattress.</p>	<p>Seek shelter in a building (not a car or mobile home) immediately. If no shelter is available, lie flat in a low dry spot (ravine or ditch) or under a low bridge. Keep alert for flash floods. Protect your head. As a last resort, hang on tightly to the base of a shrub or small tree.</p>	<p>Do not stay in a vehicle or mobile home and do not try to outrun a tornado by driving especially in populated areas. If possible run to a nearby solid structure (shelter or building). If no solid structure is nearby, lie flat in a dry ditch or ravine outside. Keep alert for flash floods. Protect your head.</p>
 <b>HAIL</b>	<p>Stay away from windows and glass doors. Be alert for signs of high winds or a tornado (especially if the hail is large) and follow tornado precautions if necessary.</p>	<p>Seek cover, face away from wind and protect your head. Be alert for signs of high winds or a tornado (especially if the hail is large) and follow tornado precautions if necessary.</p>	<p>Keep head and face away from windows. Be alert for signs of high winds or a tornado (especially if the hail is large) and follow tornado precautions if necessary.</p>